

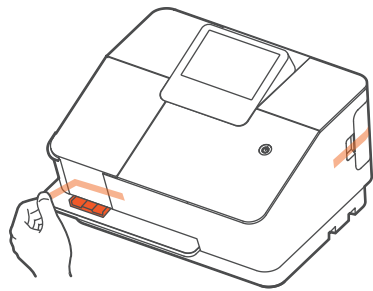

## 1. Unpack the device.

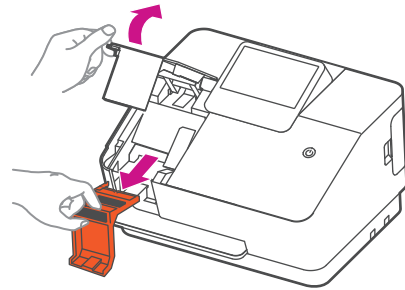

Remove all packing material from the device before assembly.



 Open the ink cover and discard the orange protector.

 STOP. Don't install the ink cartridge until prompted on the display.

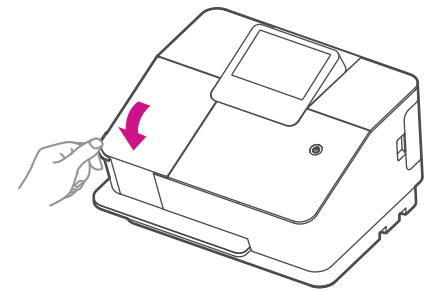

Close the ink cover.

## 2. Connect the device to a power source and continue installation steps.

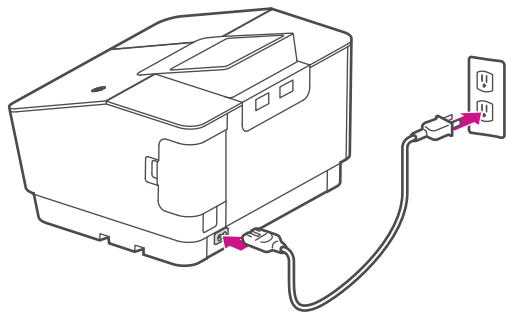

Connect the device to a power source and turn on the power switch.

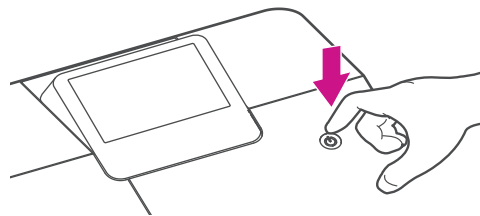

**Wait for system startup...** Then tap "Get Started" on the touchscreen and continue installation steps.